

# TENSE

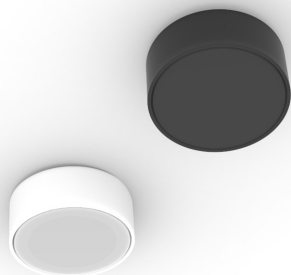

White KNX Motivity Plus



Black KNX Motivity Plus

White KNX Motivity Plus  
Code: KNX\_MOTPLUS\_W

Motion Detection  
Temperature Sensor  
Registers Brightness

Black KNX Motivity Plus  
Code: KNX\_MOTPLUS\_B

Motion Detection  
Temperature Sensor

## SPECIFICATIONS

Power supply: **min. 21 V DC. max 31 V DC** supplied by the KNX bus line

Maximum power consumption: **120 mW**

Connection to the bus: **pluggable** terminal

Operating temperatures: **-5 °C to +45 °C**

Maximum humidity: **93% relative humidity**, no moisture condensation

Type of protection (EN 60529): **IP52** (installed in ceiling)

Dimensions in mm (w x h): **30 x Ø 73 mm**

## INSTALLATION INSTRUCTIONS:

1. **Remove power** from the KNX bus.
2. **Connect** the Motivity with the **KNX bus** using the KNX connector.  
Connect the **red bus** wire to the terminal labelled with **(+)** and the **black bus** wire to the terminal labelled with **(-)**
3. **Mount** the Motivity Plus.
4. **Re-power** the KNX bus.
5. **Place** the delivered **magnet** over the sensor head.
6. Make sure the red programming **LED lights up**.
7. In ETS, add the device and **assign the physical address**.
8. **Program** the physical address to the device.
9. In ETS, select the appropriate parameters and **assign the group addresses**.
10. **Download** the application program to the device.

## MOTIVITY PLUS



The Motivity Plus is the surface-mount detector for **in- and outdoor** use. The Motivity Plus has a very **elegant design**, **no visible lens** and is **weatherproof**.

It is a **motion detector** with **integrated temperature and light sensor** (white version only). With the **internal sensor** (or using an external one), the integrated thermostat can be used to **control the room temperature**.

Its output function and behaviour are programmable by setting the appropriate parameters in **ETS**. It supports **switching, dimming and setting scenes** for up to four selectable output blocks. Additionally it also has a **scene module, programmable logic ports, timer and up/down counter** functionality.

Mounted on the wall or ceiling, this sensor has a **360° view**, a minimal **angle of 92°** and a detection diameter shown in the table on the left hand side. The sensor is surface mount, but **can be made 100% recessed** with the Trimless Wallbox delivered by Xillo®.

- The Motivity Plus is equipped with an **infrared movement detector**.
- An internal **temperature sensor** with correction.
- The Motivity Plus has an internal **light sensor** which can be corrected through **calibration with a photometer**. The light sensor has **light read out value**.
- With the **master/slave mode** it is possible for the Motivity Plus and other devices to control the action of the device programmed as master.
- Up to **four** different **output actions** available which can be independently activated on certain conditions. Possible output actions: **switching, dimming, recalling scenes, 1 or 2 Byte unsigned value, up/down, programmable logic ports...**
- The Motivity Plus has been equipped with a **switch-off delay**.
- It is possible to **control** your **ventilation** through the Motivity Plus.
- **Blocking object**.

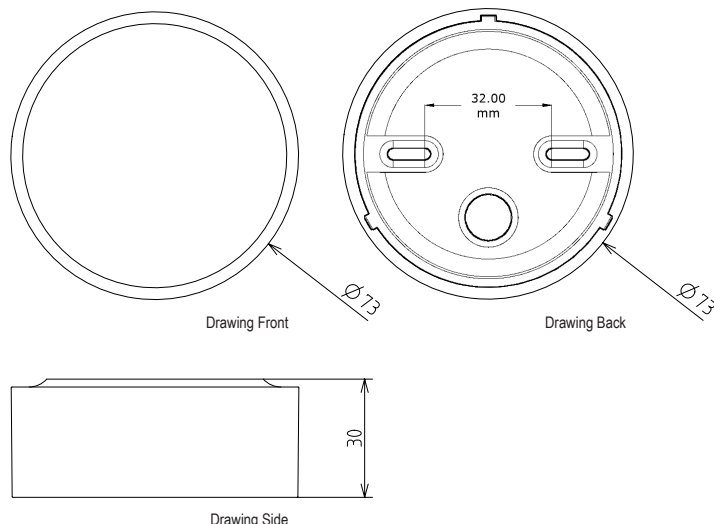

## PROJECTION ZONE

The Motivity Plus detects up until a distance of 12m. Absence or presence of detection cannot be guaranteed for a detection length of over 10m.

The projection zone of the Motivity Plus has an eleptical shape. The x-axis and y-axis have a different diameter. Below the projected detection zone per meter height is depicted both graphically and schematically.

INSTALLATION HEIGHT	ELEPTICAL AXIS X	ELEPTICAL AXIS Y
1.00 m	2.50 m	2.10 m
2.00 m	5.00 m	4.20 m
3.00 m	7.50 m	6.30 m
4.00 m	10.00 m	8.40 m
5.00 m	12.50 m	10.50 m
6.00 m	15.00 m	12.60 m
7.00 m	17.50 m	14.70 m
8.00 m	17.90 m	16.70 m
9.00 m	15.90 m	15.90 m
10.00m	13.30 m	13.30 m
11.00m	9.60 m	9.60 m

## GRAPHICAL REPRESENTATION

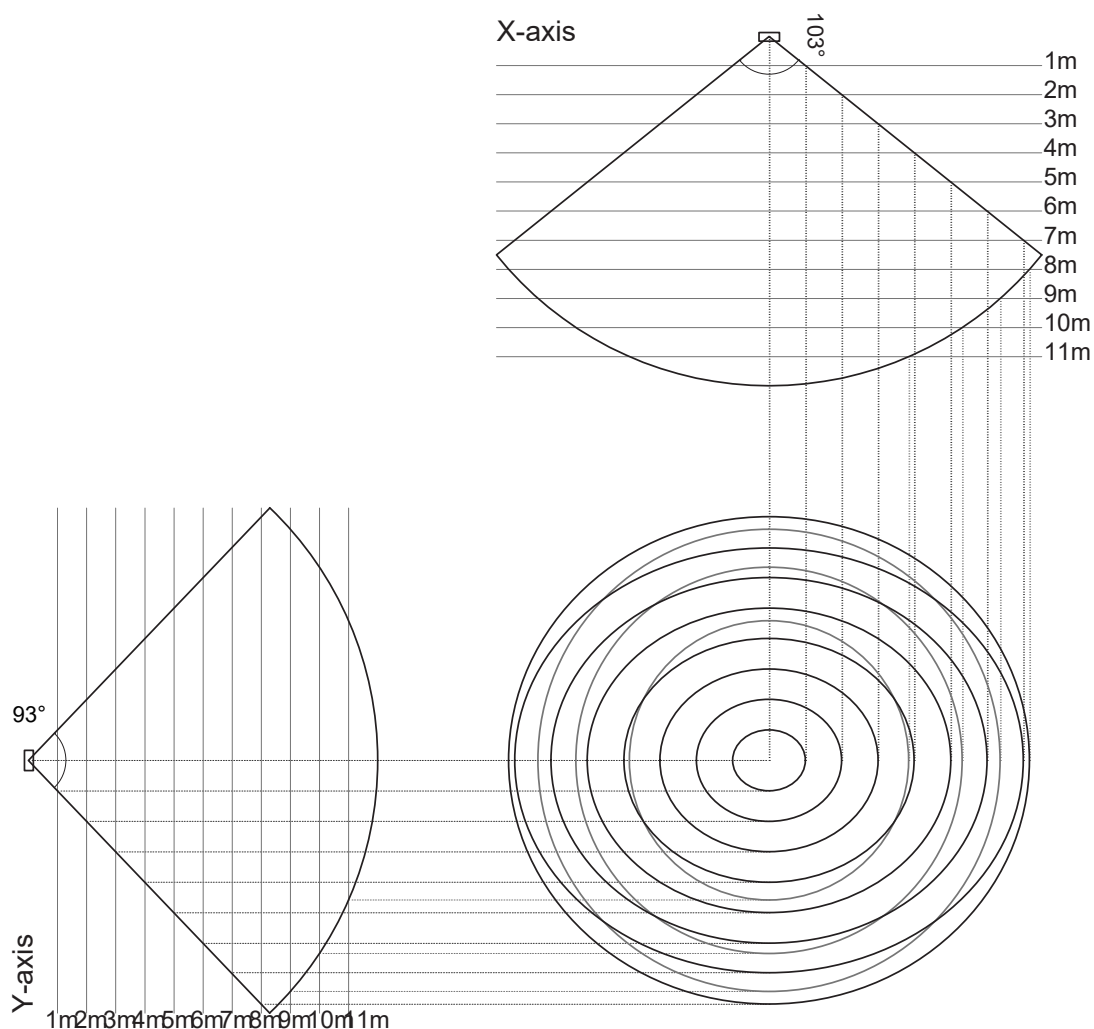

## ACCESSORIES:

The Motivity Plus can be completed by using additional accessories.

### MOTPLUS ANGLE ACCESSORY

- MOTPLUSANGLE

With the **45° tilt** accessory a **narrower detection zone** and **smaller blind spot** is created when the Motivity Plus is installed on the wall with the aid of the **spacer**. The Motivity plus is **tilted 45°** causing the blind spot of the wall mounted Motivity Plus to be **reduced from 45° to 0°**.

See the **MotPlus Angle data sheet** for more information.



MOTPLUSANGLE & MOTPLUS\_W

### TRIMLESS WALLBOX

- TRIM\_MOTPLUS\_BC (brick/concrete)  
- TRIM\_MOTPLUS\_P (plasterboard)

The sensor is surface mount, but can be made 100% **recessed** with the **Trimless Wallbox** delivered by Xillo®. The fixture is in one piece and completely made of the **solid patented composite**, so no need for an extra mounting kit. Easily install this wallbox in the ceiling or wall thanks to the **pre-drilled holes**. The unique layered design and the handy indicators for laser positioning, make sure that every fixture is **easy to plaster**. In addition, the typical Xillo pattern and large mounting surface ensure that the plaster is always **perfectly fixated**.

See the **Trimless MotPlus Wallbox data sheet** for more information.



TRIM\_MOTPLUS & MOTPLUS\_W

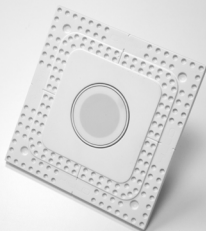

TRIM\_MOTPLUS & MOTPLUS W